

KNX SERVER

TECHNICAL DATASHEET



GENERAL OVERVIEW

Web-based visualisation system for home and building automation based on the world wide bus standard KNX. Allows the full control of the connected modules through PC/MAC, touch panels, smartphones, tablets and any kind of device equipped with a recent type of web browser, both locally and remotely through the internet.

Customizable graphical interface with a dark and a bright themes to choose from; optimized for the visualisation on different mobile and fixed devices. Direct import of the ETS project with simplified creation of the visualisation thanks to customizable import rules. Various extension possibilities thanks to functions like scenarios, time schedulings, logics, conditions, integrators, virtual objects, notifications on screen and via mail, as well as support for VoIP integrations.

Configuration possible directly on the server as well as offline via our Project Development Kit (PDK), available for free on our website; the configuration and creation of the visualisation requires no special skills / knowledge. Connection to systems of other manufacturers possible through various special modules.

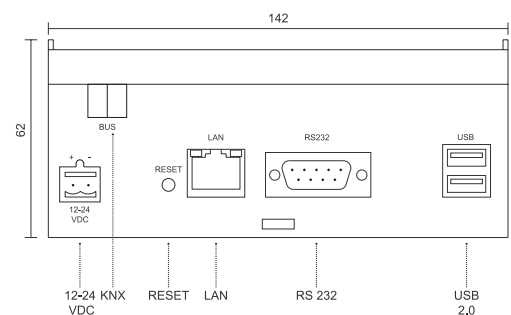
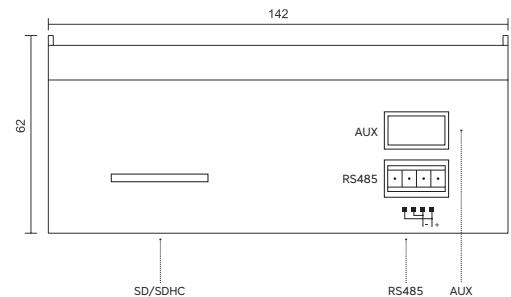
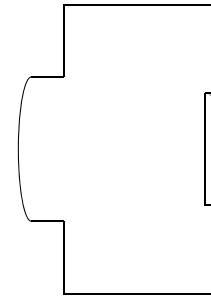

HARDWARE SPECIFICATIONS

Power Supply	12 ... 24 VDC Connector with screw connections Input with polarity protection
Power Consumption	3W (240mA at 12V)
Interfaces	KNX Standard KNX connector RS232 (1x) D-SUB 9 pin male USB 2.0 (2x) LAN (1x) RJ45 interface (10/100Mbps) RS485 (1x)
Storage interfaces	SD / SDHC Cards
Reset	Hardware button on side of case
LED	Red (1x) Reset / Error Green (1x) Power LED
Protection Grade	IP 20 (following EN 60529)
Protection Class	II (following EN 60335-1)
Temp. Range (Usage)	+0°C ... +50°C
Temp. Range (stocking)	-10°C ... +70°C
Dimensions	142 x 98 x 62 mm DIN mounting, 8 modules
Material	Auto-extinguishing plastic case (AE)

FUNCTIONALITIES

Number of KNX group addresses	2500
Number of scenes	100
Number of time functions	unlimited
Schedules	✓
Advanced logics	3 x 15
Energy counters	36
IP cameras	25
Number of rooms	100
INTERCOM	1x ext + 3x int
Data-Log with real time graphs	15 Data points ²
Scripting module	✓
Modbus	20 register ²
Alexa, Google Home	✓
Sonos, HUE, IFTTT	✓
Anwesenheitssimulation ¹	✓
Astronomische Uhr ¹	✓

¹ Release 2021

² Expandable with additional module

WIRING DIAGRAMM

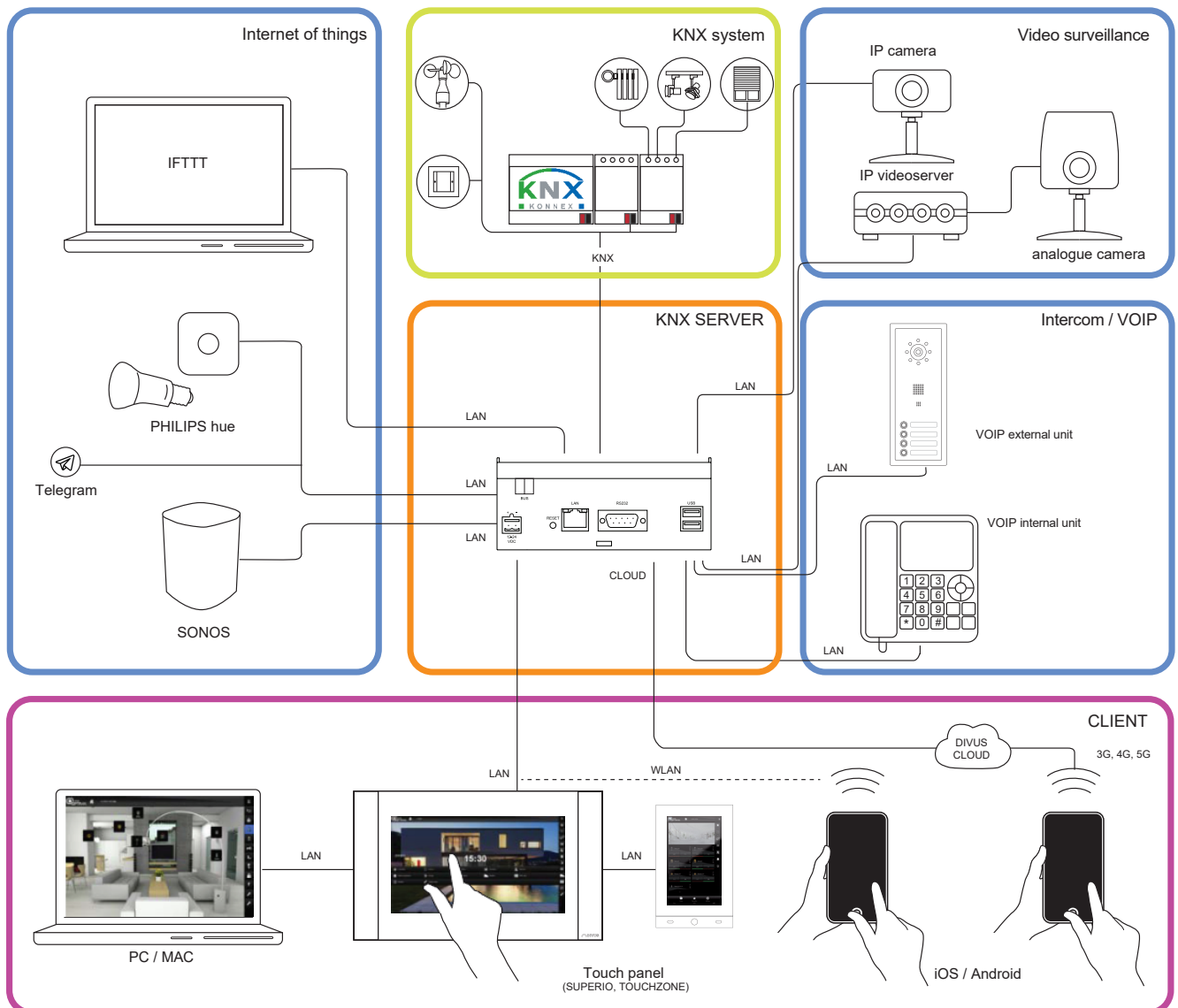

SOFTWARE SPECIFICATIONS	
Standard technologies	KNX VoIP / SIP RS-232 / RS485 / TCP
Gateway	Usable for KNX programming
User interface	Web / HTML5 (All operating systems) App support (iOS / Android)
Client amount	Unlimited (no additional license costs)
Parallel connections	Up to 20 (can be raised on request)
Controllable elements	Illumination Heating / Cooling Door and window contacts Irrigation / sprinkling Thermo-control Alarm systems Energy management Load control Weather stations IP cameras Intercom Burglar protection Multiroom
Browser compatibility	Google Chrome Apple Safari Microsoft Edge
Supported operating systems	All

VISUALIZATION	
Layout	Different graphical themes Layout adapts to display resolution Automatic resize for mobile devices Support of touch and multitouch systems
Performance**	Animations and graphical effects Support for HTML5 caching Optimized for iOS and Android
Navigation	Customizable graphical pages Navigation through rooms on different levels Navigation through functionalities Complex functions with pop-up controls Navigation menu customizable and always visible Single-click access for most important functions
Customization	Favourites Home Scenarios Time scheduling
Notifications	OnScreen notifications Mail Intercom
Further services	Weather forecast RSS feeds Web browser
Voice Commands	Through Amazon Alexa or Google Home you can also command your KNX System using voice commands
Cloud	Access from anywhere via the free DIVUS Cloud

(**) Performance may vary depending on the available network connection

SETUP AND COMMISSIONING	
Configuration possibilities	Online Offline through PDK (available for free)
Configuration interface (IDE)	Search function Navigation menu with access to all functions Drag & drop Multi-Tab support for configuration of more than one object contemporarily
Setup and maintenance	Network Date / time Backup / restore of the project Language support (Italian / English / German / ...) Selection of graphical themes and layout adaptations Software update via browser
KNX visualisation	Project import from ETS Automatic creation of the functions Import rules connected to the KNX group addresses ETS gateway functionality also through internet
Rooms / pages	Arbitrary amount of pages and rooms Layout in grid and background view Background pictures freely customizable Free positioning of the functions
Extended functionality	Scenarios including wait commands Complex objects for uniting functions Logic functions Value comparisons and conditions Virtual objects Integrators Customizable functions thanks to scripting support
Timer / scheduling	daily schedulings Weekly and yearly schedulings Configuration interface for final user
History / datalog	Periodic graphical representation (hours, days, months, years) Value comparison between different periods Realtime values in graphs (refreshed every minute)
Energy management	Support for energy counters Support for load controllers Graphical display of consumption Visualisation of current load in real-time Value comparison and direct load control
Notifications	OnScreen notifications (3 level) Mails Push notifications Through IFTTT Through Telegram Intercom
VoIP - Intercom	1 external unit 3 internal units Call groups Automatical pop-up of incoming calls More than one video signal per external unit configurable Door opener Usable through any SIP compatible devices
Connection to third-party software	URL SOAP M2M
Customization	Customizable graphical elements Different graphics selectable for the functions Integrated scripting routing for function extensions Import / export libraries for further usage
Users and security	Arbitrary amount of users Free distribution of user permissions Automatic login thanks to trusted IP configuration SSL protected remote access
Graphic logic editor	Extended logic functions library Up to 3 logic functions with max. 15 tasks each

ADDITIONAL MODULES - UPGRADES KNX SERVER

ADDITIONAL MODULES & UPGRADES KNX SERVER	UP-M	Upgrade from the previous model KNX M-SERVER to the current KNX SERVER, all features of DIVUS KNX SERVER become available with this upgrade
	UP-H	Upgrade from the previous model KNX H-SERVER to the current KNX SERVER, all features of DIVUS KNX SERVER become available with this upgrade
	UP-DATALOG-SW	In DIVUS KNX SERVER it is possible to record any values graphically. The UP-DATALOG-SW extends this feature from max. 15 to max. 60 values such as temperatures, brightness, status feedback, percentage values etc. Various types of graphical representation are available, whereby the graphical output may be optimally adapted to the respective purpose. This allows the user to get an overview of the current situation in an easy way.
	UP-MODBUS-SW	The DIVUS KNX SERVER can be connected via modbus protocol with other devices using that protocol. Thereby it is possible to establish the connection by cable or by modbus TCP/IP via the local network. In this way, third-party systems can be implemented via the modbus standard into the visualization. With UP-MODBUS-SW, the default limit of 20 registers is brought up to 150.